



Drilling Unit FD3-80



■ Specification

Pneumatic Pressure	55 ~ 85 P.S.I
Drilling Capacity	3/16" (steel) 70 P.S.I
Chuck Type	ER-16-3/8", JT1-1/4", JT2-3/8"
Power	0.5HP-2p or 4p, 200V/440V-60HZ
Max. Revolution/Minute	6,000rpm
Weight	48 lb
Overall Stroke	3"
Drilling Stroke	1" or 2"
Cylinder Diameter	2"
Cylinder Area	Forward 2.45 IN ² , Backward 1.1 IN ²
Transmission Pulley	V-SHAPE, 189J, 201J
Thrust Force	174 lb @ 70 P.S.I

■ Consumption Parts

Spindle Bearing	6002Zx2, 6001ZZx1
Pulley Bearing	6203ZZx2
O-Ring for Front Cover	GLY-40x1, N-50x1, DKB-40-52-6x1
O-Ring for Piston	OSY-50x2
O-Ring for Rear Cover	P-22x1, P-22Ax1, SER-22x1
O-Ring for Sleeve	d1-50x2

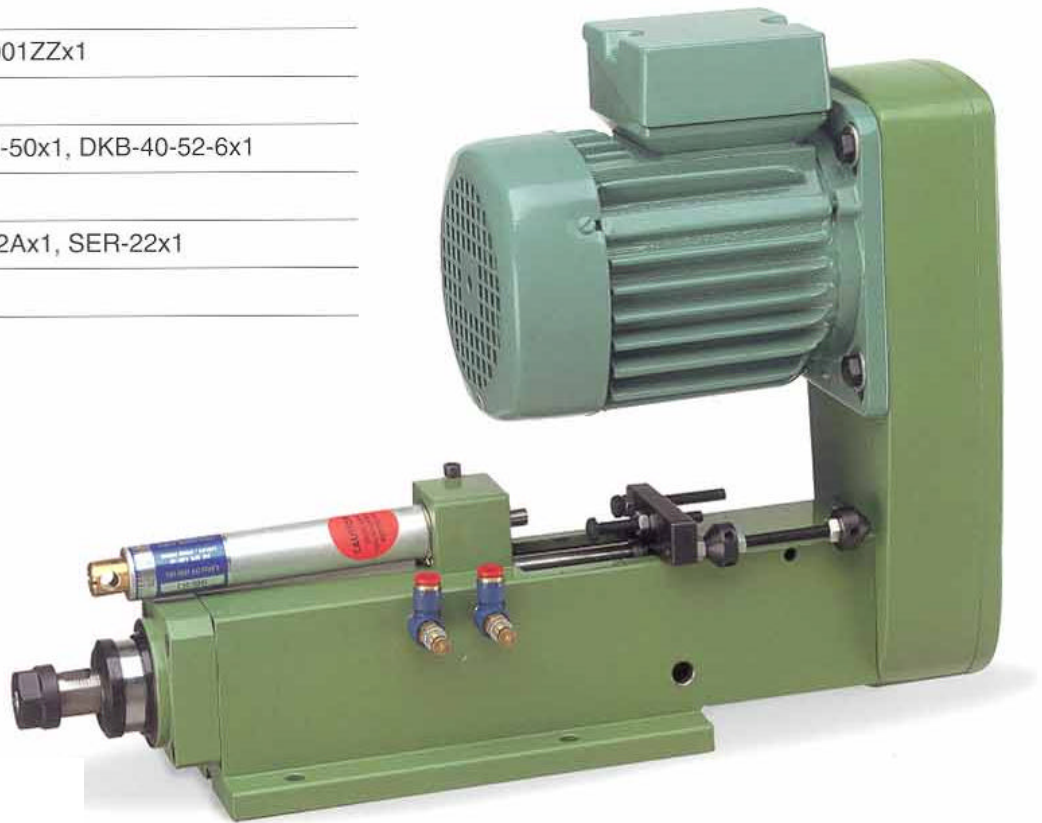

Hause Machines, Inc.
809 S. Pleasant St.
P.O. Box 229
Montpelier, OH 43543

Phone 419-485-3158
Toll Free 800-932-8665
Fax 419-485-3146
E-mail hause@bright.net
Web Page www.hausemachines.com

- RPM and chuck type should be given when placing order.
- There are two drilling strokes to choose from 1" and 2".
- Selection of pneumatic or electrical micro switch.
- Motor and pulley can be mounted around the circle in 45 degree interval.



Drilling Unit FD3-80

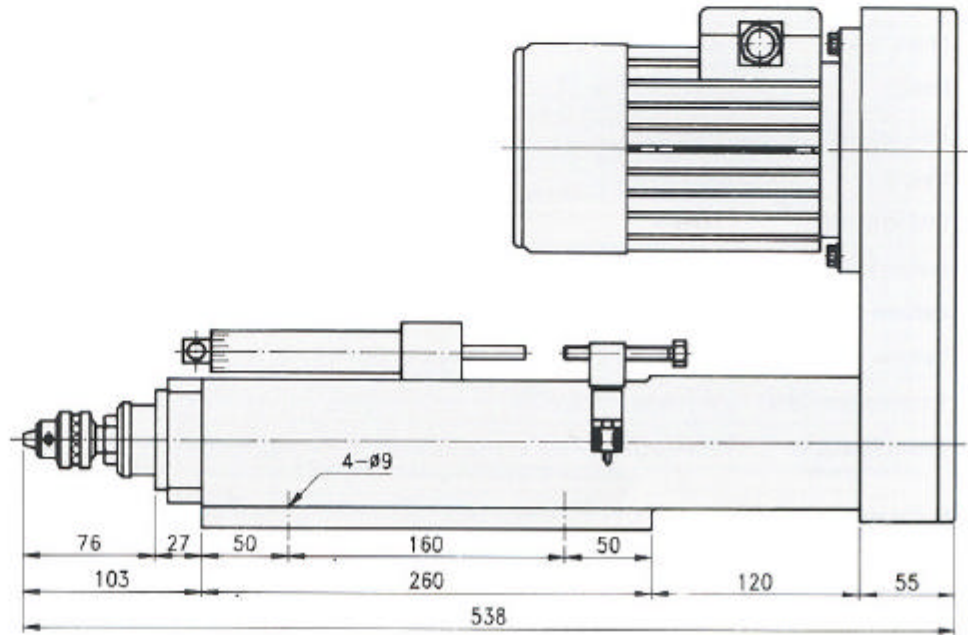
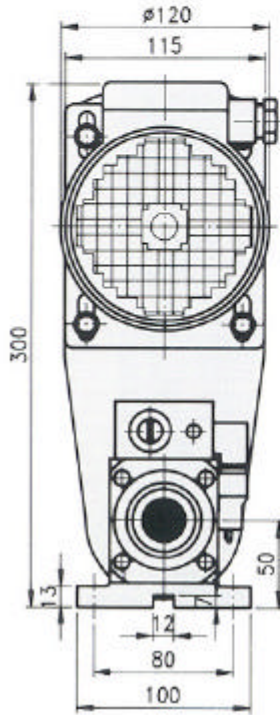

FD3-80-JT1

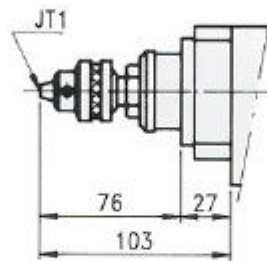

FD3-80-JT2

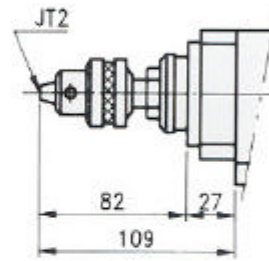

FD3-80-ER16

