



# Tapping Unit F6N-60



## ■ Specification

Tapping Capacity	1/2" (steel)
Stroke	2.5"
Thread Pitch	64UNF ~ 16UNF
Gauge Lubrication	Grease
Weight	40 lb

## ■ Consumption Parts

Spindle Bearing	6004Zx2
Pulley Bearing	60062RSx2, 6906ZZx1



**Hause Machines, Inc.**  
**809 S. Pleasant St.**  
**P.O. Box 229**  
**Montpelier, OH 43543**

Phone 419-485-3158  
Toll Free 800-932-8665  
Fax 419-485-3146  
E-mail [hause@bright.net](mailto:hause@bright.net)  
Web Page [www.hausemachines.com](http://www.hausemachines.com)

- The unit is mounted with high precision, grinding master gauge for precision and fine tapping works.
- Thread pitch should be given when placing order.
- Master gauge is mounted externally to the end of unit for easy and quick change.
- Horizontal and vertical application are available, oil cup should be adjusted accordingly.
- For mounting multiple spindle to this tapping unit, nose type: F6N-60-JT6 is recommended.



# Tapping Unit F6N-60

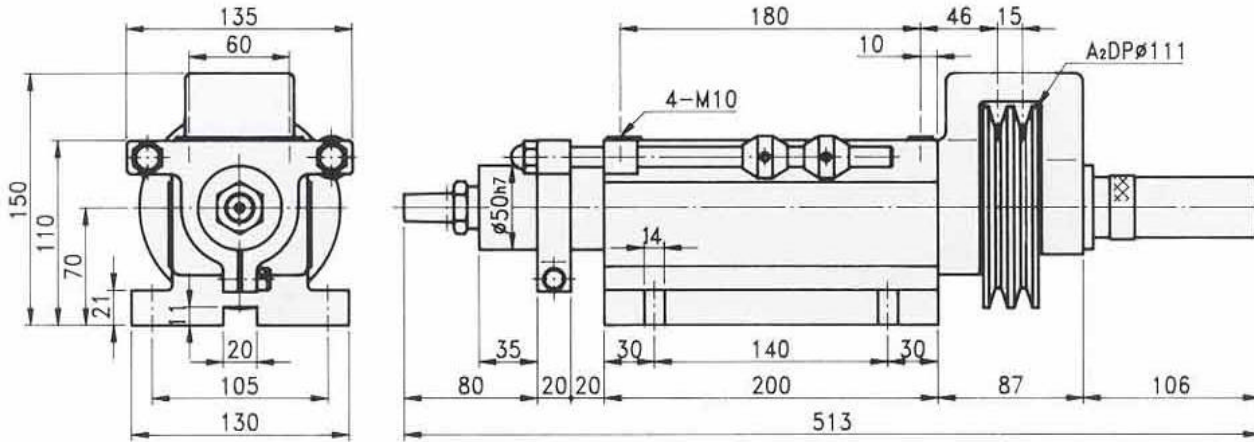

## F6N-60-AS22

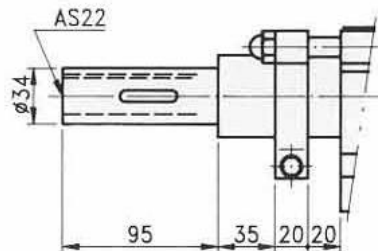

## F6N-60-ER20

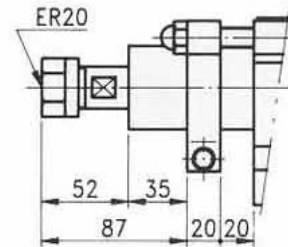

## F6N-60-JT6

