











Collet Specification

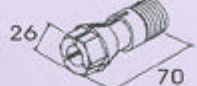

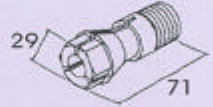
| | | | |
|--|--|--|--|
| <p>CT Type (for tapping)</p>  <p>C Type (for drilling)</p>  <p>CS Type (for drilling with thread)</p>  <p>Order Formula: Type x Shank Diameter x Quantity Ex.:CT9 x \varnothing12mm x 4pcs</p> | <p>D-4 DT-4</p>  <p>\varnothing1.1~\varnothing4.0</p> | <p>C-9 CT-9</p>  <p>\varnothing3.0~\varnothing8.0</p> | <p>C-16 CT-16</p>  <p>\varnothing10.0~\varnothing16.0</p> |
| | <p>C-5 CT-5</p>  <p>\varnothing1.1~\varnothing5.0</p> | <p>C-12 CT-12</p>  <p>\varnothing6.1~\varnothing11.0</p> | <p>C-20 CT-20</p>  <p>\varnothing10.0~\varnothing20.0</p> |
| | <p>C-6 CT-6</p>  <p>\varnothing1.1~\varnothing6.0</p> | <p>C-14 CT-14</p>  <p>\varnothing6.0~\varnothing13.0</p> | <p>C-30 CT-30</p>  <p>\varnothing18.0~\varnothing30.0</p> |

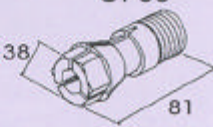
Remark: If you are using for following tools, please specify: reamer, end mill, chamfering tool, high pitch drill, left turn tap.

Floating Spindle Adapter (for tapping and reaming application)
Patent No.: 79022

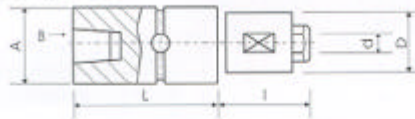

Floating Spindle Adapter (for tapping and reaming application)
Patent No.: 79022



| ER20 | |
|------------------|---------------------|
| D | Max. Shank diameter |
| \varnothing 32 | \varnothing 13 |

Extension Bar (Length can be specified)

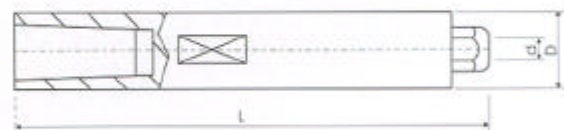

| type | size | A | B | L | l | D | d | Remarks |
|--------|------------------|----------------|-----|----|------------------|------------------------------------|---|---------|
| FCJ-5 | \varnothing 26 | JT2,JT6 | 65 | 46 | \varnothing 12 | \varnothing 2~ \varnothing 5.5 | | |
| FCJ-6 | \varnothing 26 | JT2,JT6 | 65 | 50 | \varnothing 17 | \varnothing 2~ \varnothing 6 | | |
| FCJ-9 | \varnothing 26 | JT2,JT6 | 65 | 66 | \varnothing 19 | \varnothing 3~ \varnothing 8 | | |
| FCJ-9 | \varnothing 34 | JT6 | 72 | 37 | \varnothing 26 | \varnothing 3~ \varnothing 8 | | |
| FCJ-9 | \varnothing 34 | M17 x P1.0+JT2 | 77 | 37 | \varnothing 26 | \varnothing 3~ \varnothing 8 | | |
| FCJ-9 | \varnothing 34 | M20 x P1.0+JT6 | 78 | 37 | \varnothing 26 | \varnothing 3~ \varnothing 8 | | |
| FCJ-12 | \varnothing 34 | JT6 | 72 | 37 | \varnothing 26 | \varnothing 6~ \varnothing 11 | | |
| FCJ-12 | \varnothing 34 | M17 x P1.0+JT2 | 77 | 37 | \varnothing 26 | \varnothing 6~ \varnothing 11 | | |
| FCJ-12 | \varnothing 34 | M20 x P1.0+JT6 | 78 | 37 | \varnothing 26 | \varnothing 6~ \varnothing 11 | | |
| FCJ-14 | \varnothing 34 | JT6 | 72 | 68 | \varnothing 30 | \varnothing 8~ \varnothing 13 | | |
| FCJ-14 | \varnothing 34 | M17 x P1.0+JT2 | 77 | 68 | \varnothing 30 | \varnothing 8~ \varnothing 13 | | |
| FCJ-14 | \varnothing 34 | M20 x P1.0+JT6 | 78 | 68 | \varnothing 30 | \varnothing 8~ \varnothing 13 | | |
| FCJ-16 | \varnothing 58 | JT3 | 98 | 43 | \varnothing 44 | \varnothing 10~ \varnothing 16 | | |
| FCJ-16 | \varnothing 58 | JT4 | 110 | 43 | \varnothing 44 | \varnothing 10~ \varnothing 16 | | |
| FCJ-20 | \varnothing 58 | JT3 | 98 | 46 | \varnothing 44 | \varnothing 13~ \varnothing 18 | | |
| FCJ-20 | \varnothing 58 | JT4 | 110 | 47 | \varnothing 44 | \varnothing 13~ \varnothing 18 | | |
| FCJ-30 | \varnothing 58 | JT4 | 110 | 48 | \varnothing 58 | \varnothing 16~ \varnothing 28 | | |

| type | size | L | B | D | d | Remarks |
|-------|------|-----|-----|------------------|------------------------------------|---------|
| JC-9 | | 85 | JT6 | \varnothing 24 | \varnothing 3~ \varnothing 8 | |
| JC-12 | | 85 | JT6 | \varnothing 24 | \varnothing 6~ \varnothing 11 | |
| JC-14 | | 92 | J16 | \varnothing 30 | \varnothing 8~ \varnothing 13 | |
| JC-16 | | 115 | JT3 | \varnothing 42 | \varnothing 10~ \varnothing 16 | |
| JC-20 | | 125 | JT4 | \varnothing 44 | \varnothing 13~ \varnothing 18 | |
| JC-30 | | 131 | JT4 | \varnothing 58 | \varnothing 16~ \varnothing 28 | |
| | | | | \varnothing 10 | \varnothing 1.1~ \varnothing 4 | |